

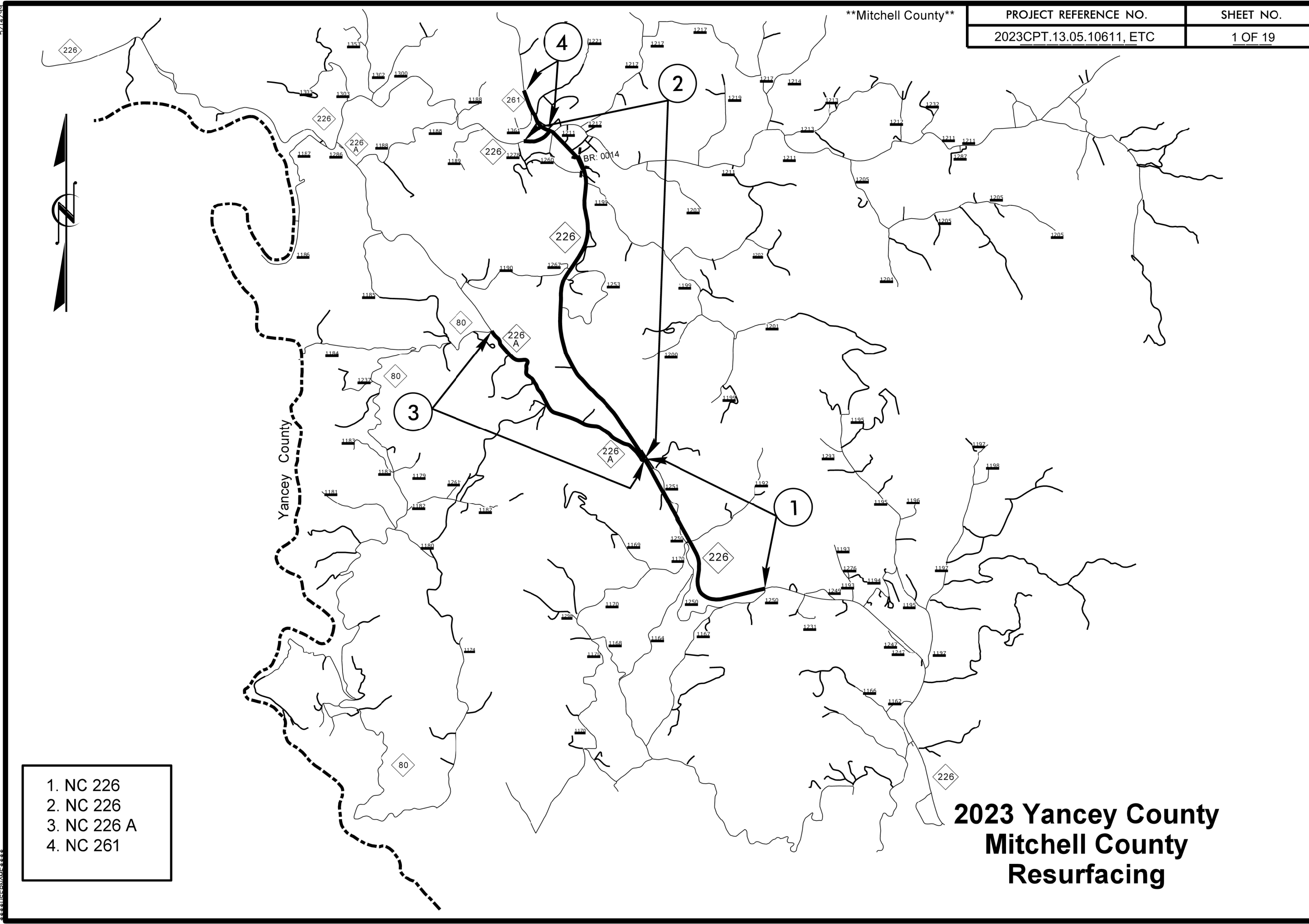

- 1. NC 226
- 2. NC 226
- 3. NC 226 A
- 4. NC 261

2023 Yancey County Mitchell County Resurfacing

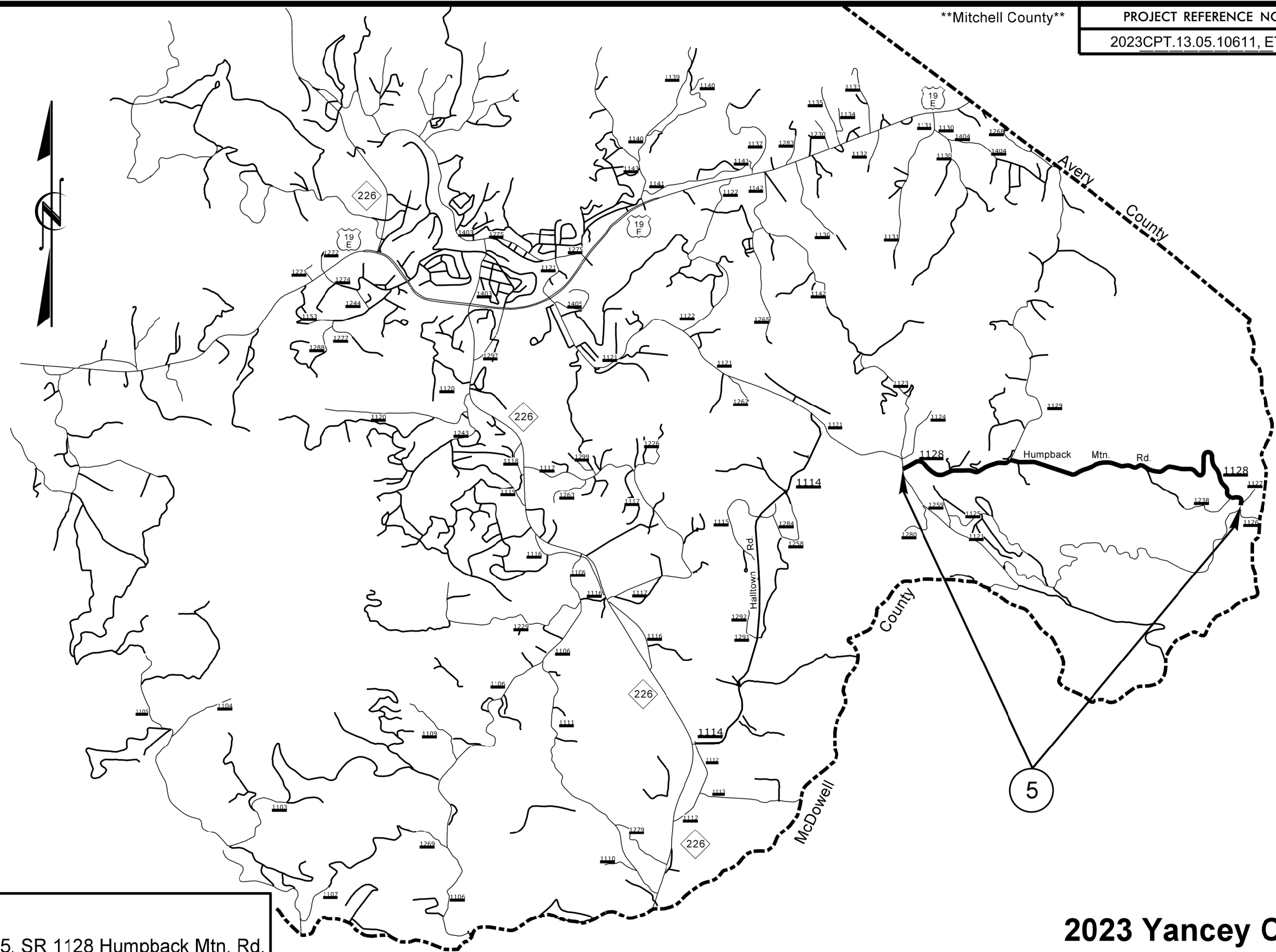



5. SR 1128 Humpback Mtn. Rd.

2023 Yancey County Mitchell County Resurfacing

C:\Users\user\Documents\2023CPT.13.05.10611\2023CPT.13.05.10611.dwg

5/14/23

Yancey County

PROJECT REFERENCE NO.
2023CPT.13.05.10611, ETC

SHEET NO.
3 OF 19

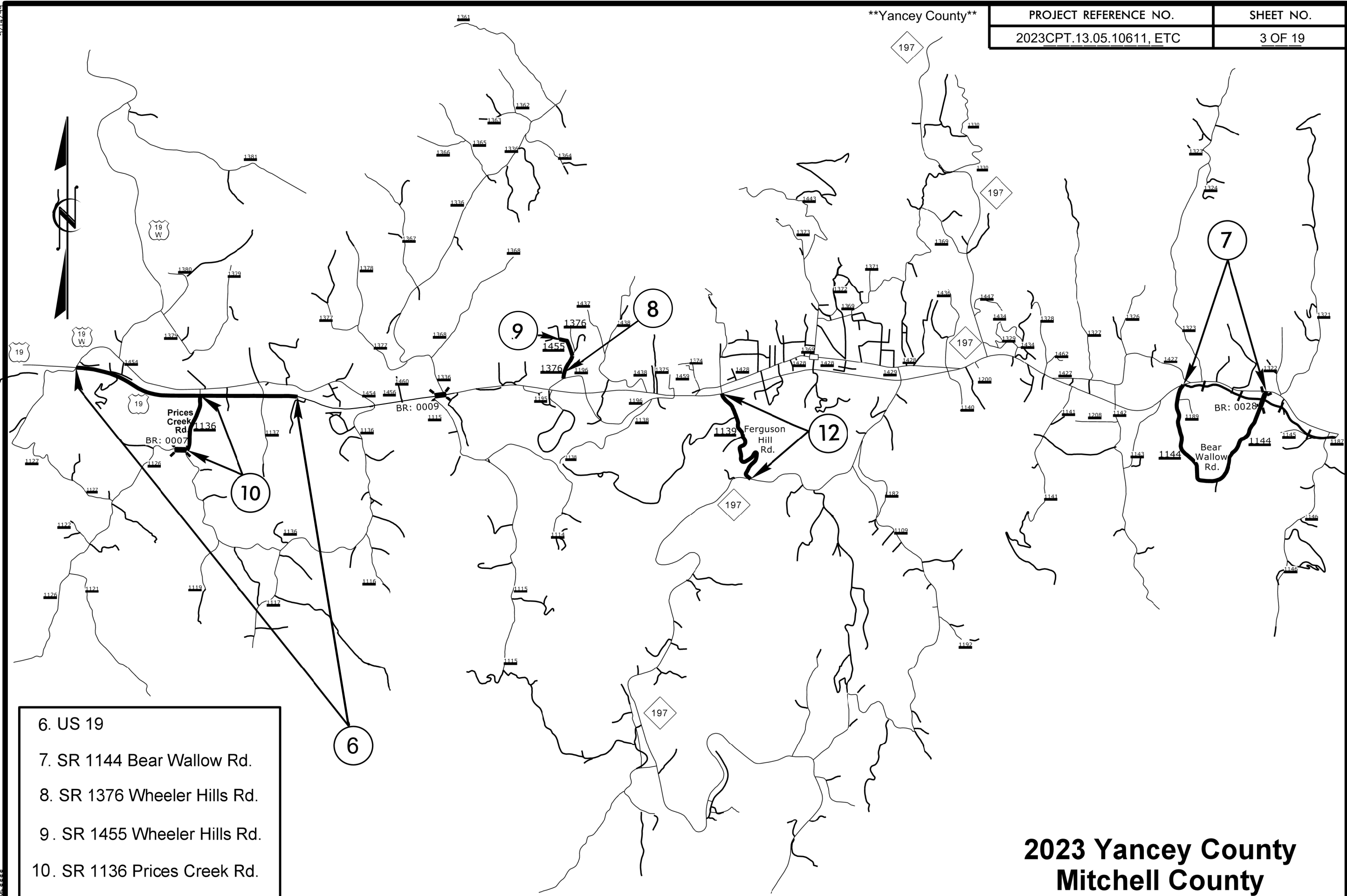

- 6. US 19
- 7. SR 1144 Bear Wallow Rd.
- 8. SR 1376 Wheeler Hills Rd.
- 9. SR 1455 Wheeler Hills Rd.
- 10. SR 1136 Prices Creek Rd.
- 12. SR 1139 Ferguson Hill Rd.

**2023 Yancey County
Mitchell County
Resurfacing**

C:\TIVE\2023\2023CPT.13.05.10611\10611.DWG

5/14/23

Yancey County

PROJECT REFERENCE NO.	SHEET NO.
2023CPT.13.05.10611, ETC	4 OF 19

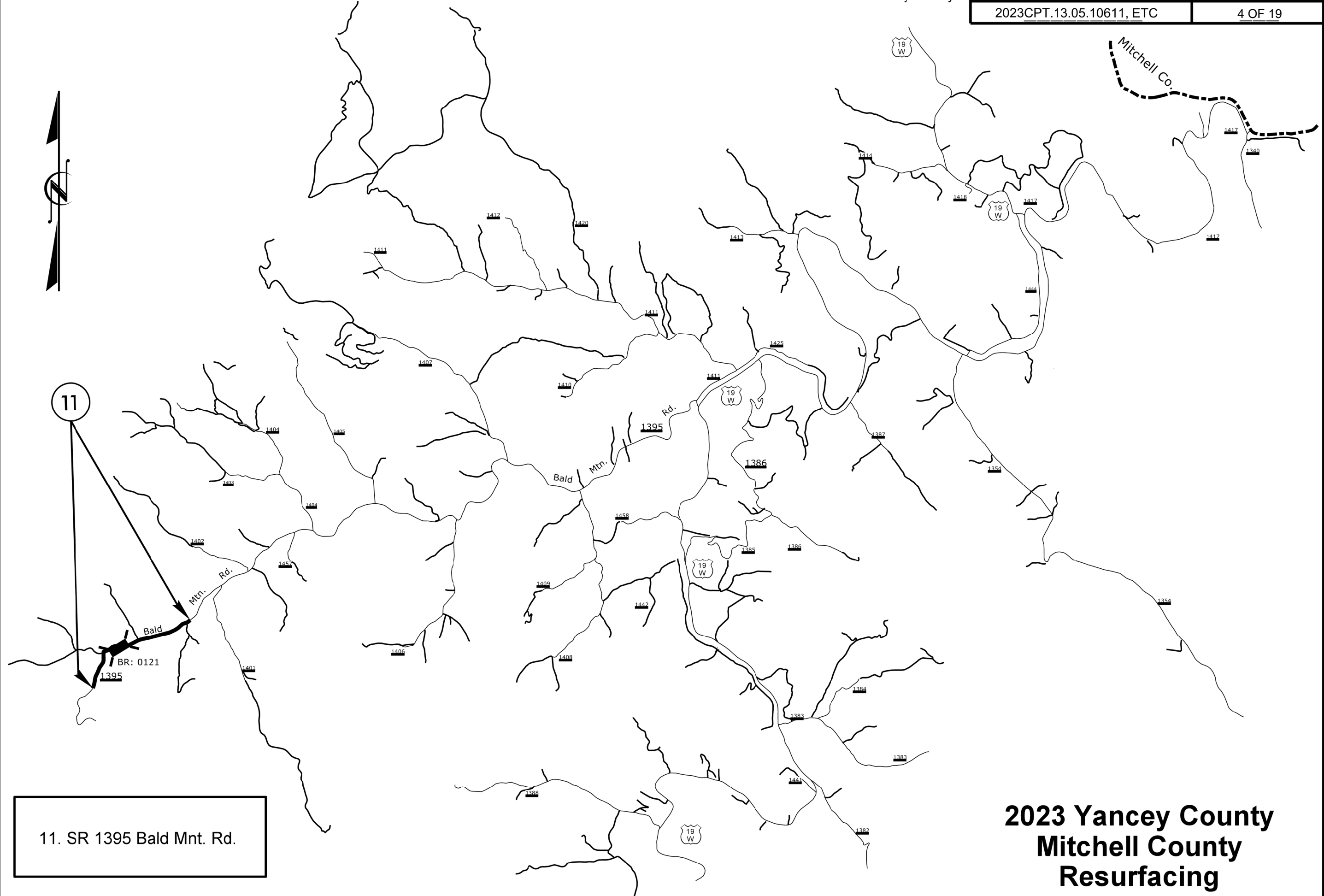

11. SR 1395 Bald Mnt. Rd.

**2023 Yancey County
Mitchell County
Resurfacing**

DATE PLOTTED: 5/14/23
 DRAWN BY: J. WILSON
 CHECKED BY: J. WILSON
 APPROVED BY: J. WILSON

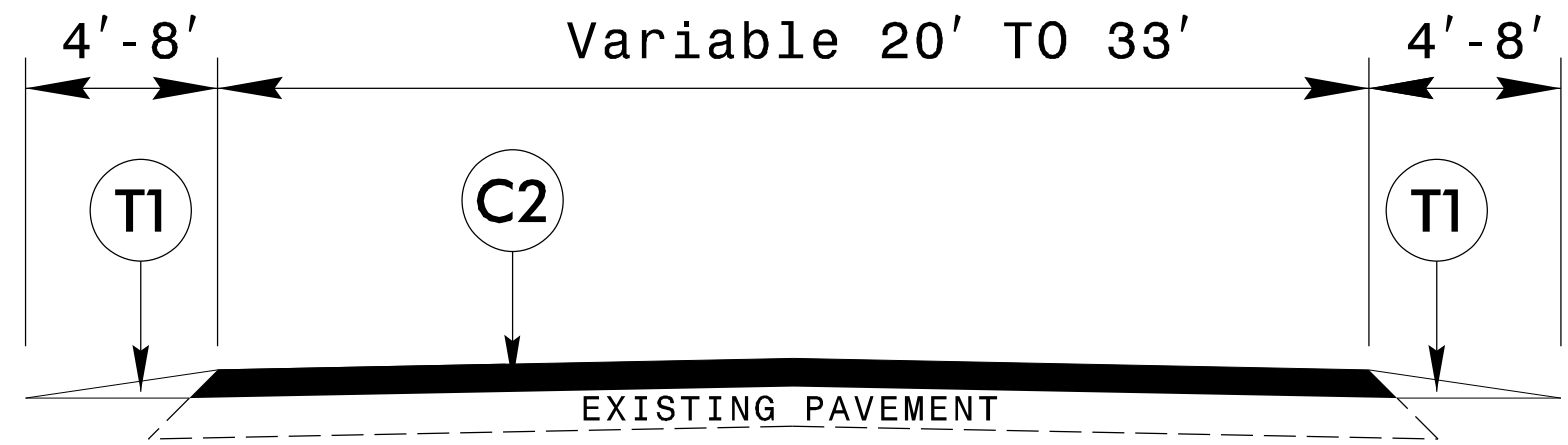

TYPICAL SECTION #1

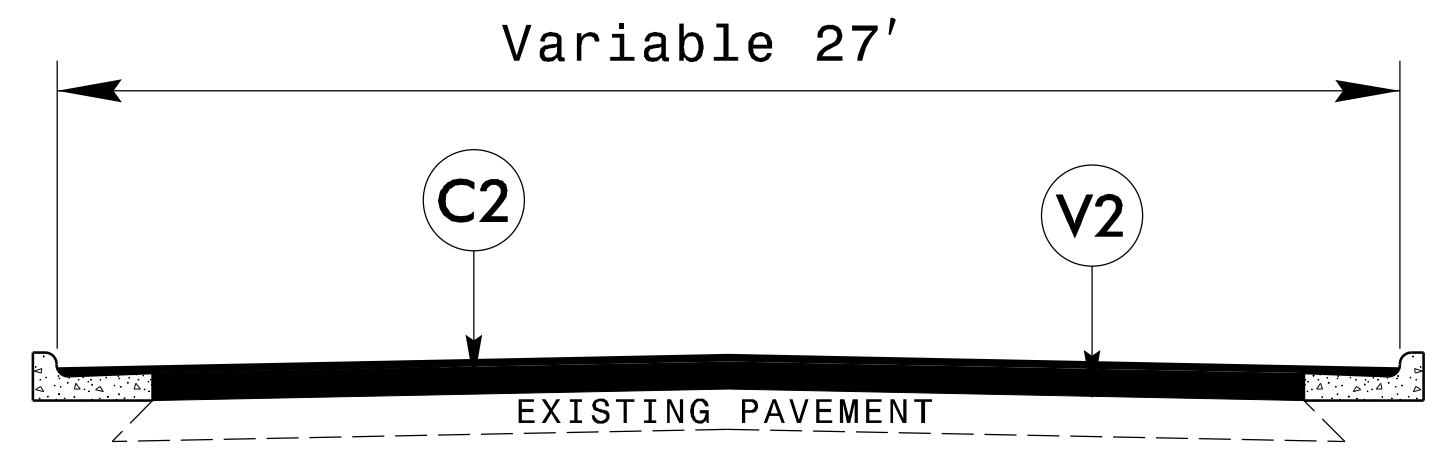

TYPICAL SECTION #2

PAVEMENT SCHEDULE	
C1	PROP. APPROX. 1-1/2" ASPHALT CONCRETE SURFACE COURSE, TYPE S9.5B, AT AN AVERAGE RATE OF 165 LBS. PER SQ. YARD
C2	PROP. APPROX. 1-1/2" ASPHALT CONCRETE SURFACE COURSE, TYPE S9.5C, AT AN AVERAGE RATE OF 168 LBS. PER SQ. YARD
T1	SHOULDER RECONSTRUCTION
V1	MILLING ASPHALT PAVEMENT, 0 TO 1-1/2" DEPTH
V2	MILLING ASPHALT PAVEMENT 1-1/2" DEPTH
V3	INCIDENTAL MILLING

26-JAN-2022 07:20
 S:\DD\Resurfacing\2023 Resurfacing District 2\Mitchell-Yancey CR.2023.ddc.typ.dgn
 \$\$\$\$ \$\$\$\$\$\$

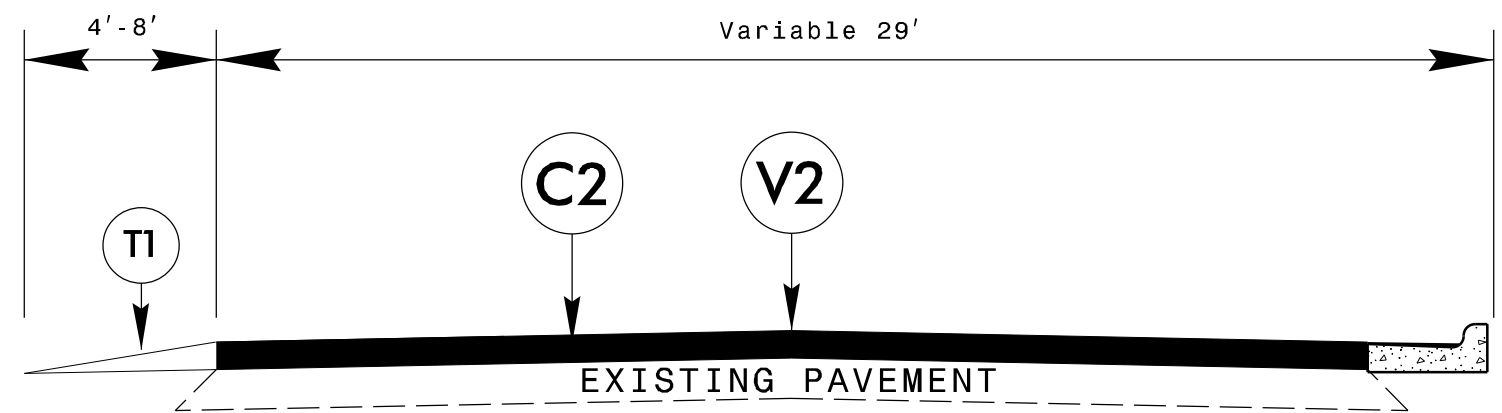

TYPICAL SECTION #3

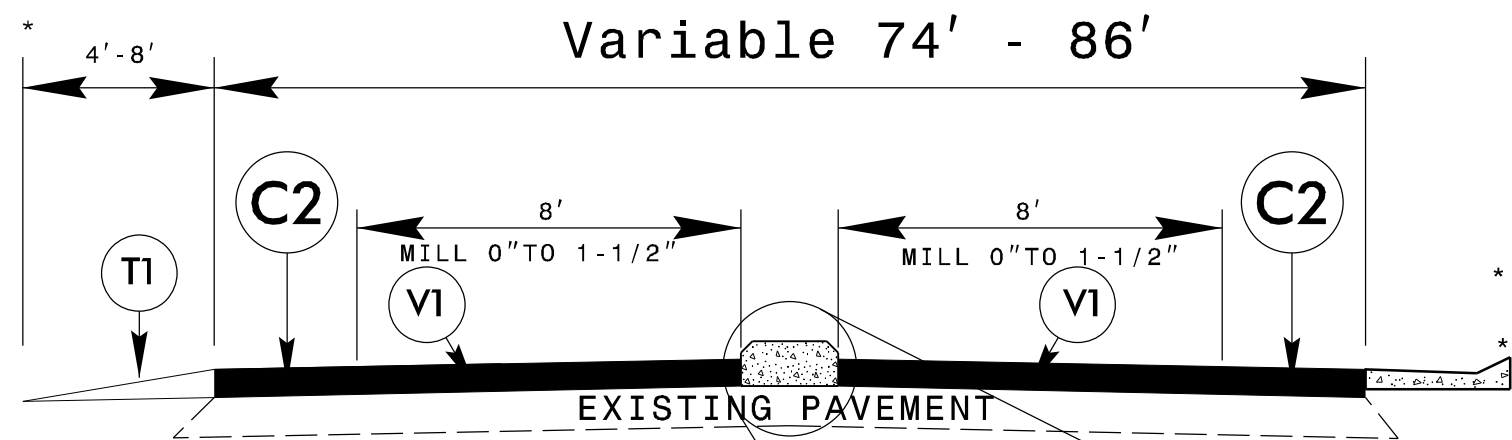

* NOTE: SEE DETAIL SHEET 10.

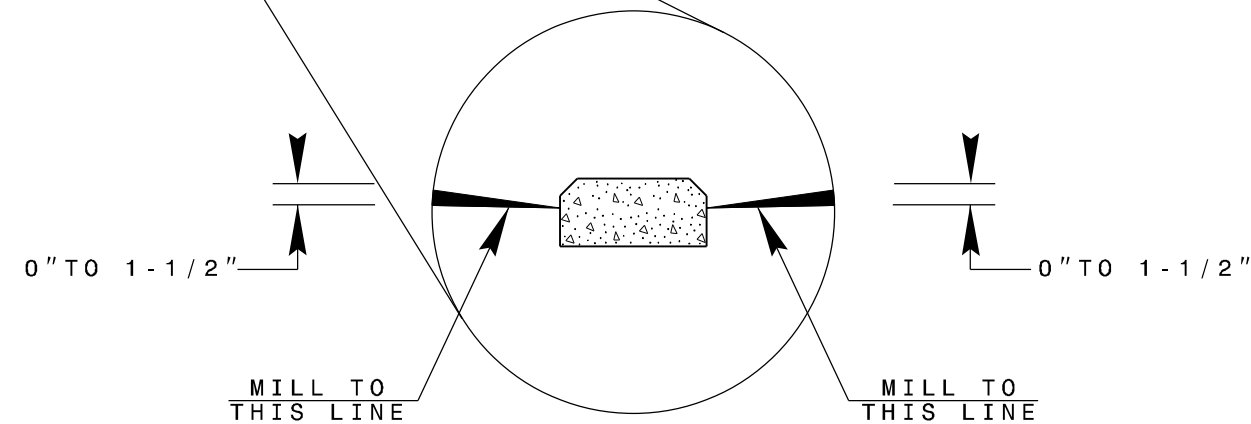

TYPICAL SECTION #4

PAVEMENT SCHEDULE	
C1	PROP. APPROX. 1-1/2" ASPHALT CONCRETE SURFACE COURSE, TYPE S9.5B, AT AN AVERAGE RATE OF 168 LBS. PER SQ. YARD
C2	PROP. APPROX. 1-1/2" ASPHALT CONCRETE SURFACE COURSE, TYPE S9.5C, AT AN AVERAGE RATE OF 168 LBS. PER SQ. YARD
T1	SHOULDER RECONSTRUCTION
V1	MILLING ASPHALT PAVEMENT, 0 TO 1-1/2" DEPTH
V2	MILLING ASPHALT PAVEMENT 1 1/2" DEPTH
V3	INCIDENTAL MILLING

26-JAN-2022 07:21
 S:\DD\Resurfacing\2023 Resurfacing District 2\Mitchell-Yancey CR.2023.ddc_typ.dgn
 6/2/99

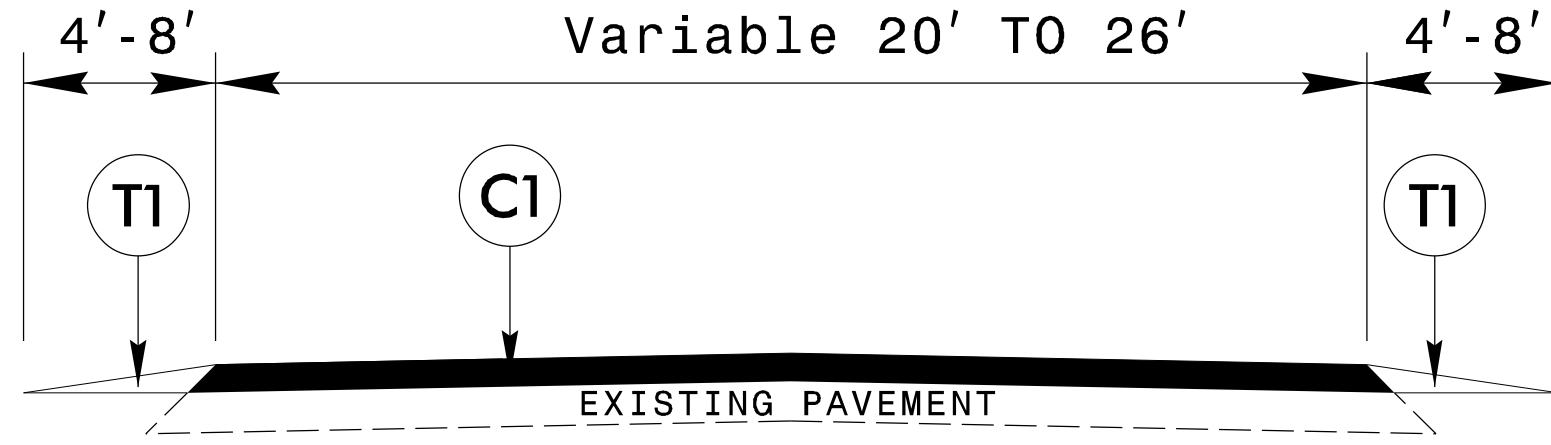

TYPICAL SECTION #5

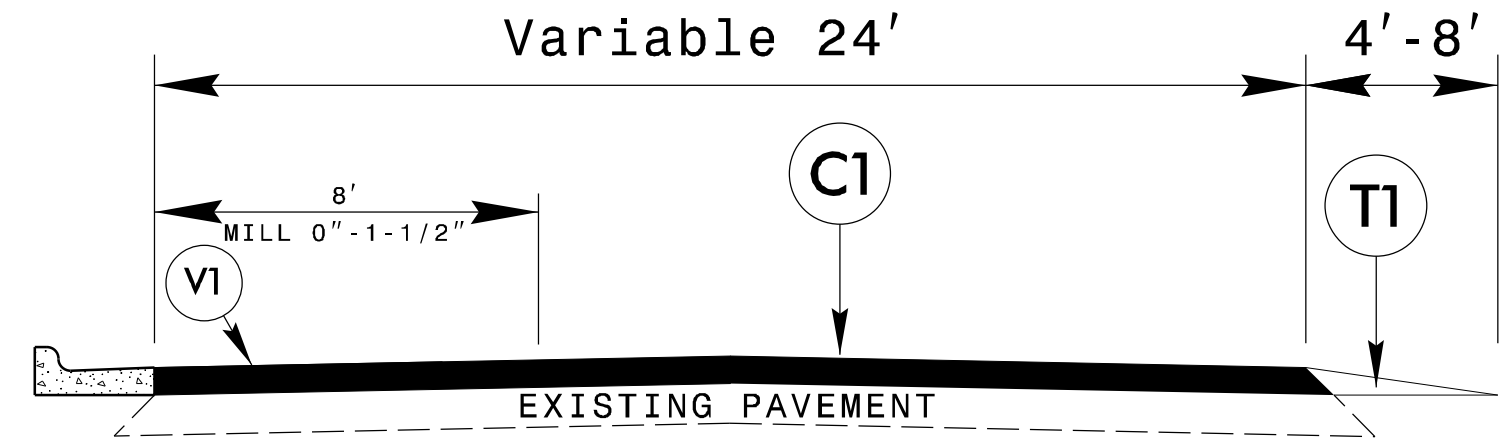

TYPICAL SECTION #6

PAVEMENT SCHEDULE	
C1	PROP. APPROX. 1-1/2" ASPHALT CONCRETE SURFACE COURSE, TYPE S9.5B, AT AN AVERAGE RATE OF 165 LBS. PER SQ. YARD
C2	PROP. APPROX. 1-1/2" ASPHALT CONCRETE SURFACE COURSE, TYPE S9.5C, AT AN AVERAGE RATE OF 168 LBS. PER SQ. YARD
T1	SHOULDER RECONSTRUCTION
V1	MILLING ASPHALT PAVEMENT, 0 TO 1-1/2" DEPTH
V2	MILLING ASPHALT PAVEMENT 1 1/2" DEPTH
V3	INCIDENTAL MILLING

26-JAN-2022 07:22
 S:\DD\Resurfacing\2023 Resurfacing\District 2\Mitchell-Yancey CR.2023.ddc_typ.dgn
 6/2/99

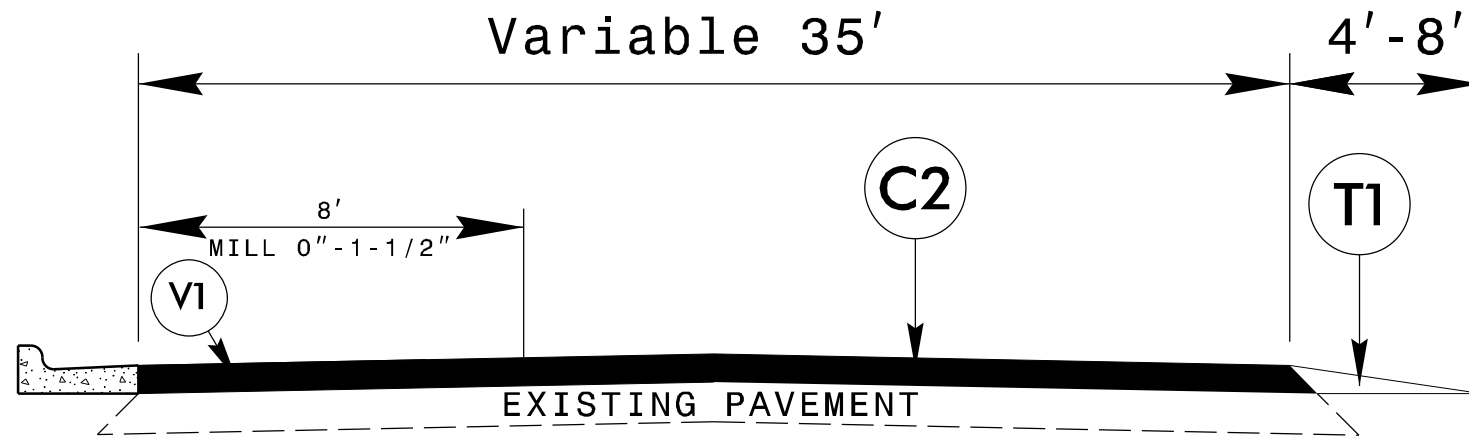

TYPICAL SECTION #7

PAVEMENT SCHEDULE	
C1	PROP. APPROX. 1-1/2" ASPHALT CONCRETE SURFACE COURSE, TYPE S9.5B, AT AN AVERAGE RATE OF 165 LBS. PER SQ. YARD
C2	PROP. APPROX. 1-1/2" ASPHALT CONCRETE SURFACE COURSE, TYPE S9.5C, AT AN AVERAGE RATE OF 168 LBS. PER SQ. YARD
T1	SHOULDER RECONSTRUCTION
V1	MILLING ASPHALT PAVEMENT, 0 TO 1-1/2" DEPTH
V2	MILLING ASPHALT PAVEMENT 1 1/2" DEPTH
V3	INCIDENTAL MILLING

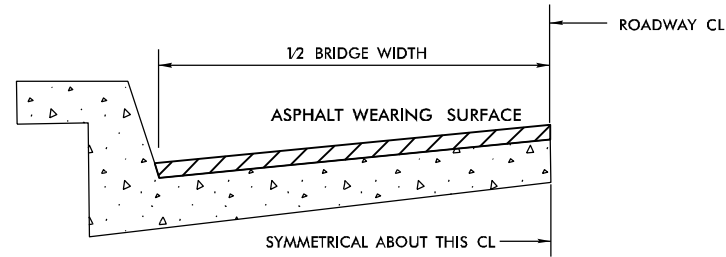

BRIDGE HALF TYPICAL SECTION

FOR BRIDGES WITH FLOOR DRAINS, CARE SHALL BE EXERCISED IN PLACING THE WEARING SURFACE AROUND FLOOR DRAINS SO AS NOT TO HINDER EFFECTIVE DRAINAGE. ALL DRAINS SHALL BE LEFT OPEN.

THE PROPOSED WEARING SURFACE SHALL VARY IN THICKNESS AS NECESSARY TO PROVIDE A SMOOTH RIDING SURFACE. THE MINIMUM THICKNESS SHOULD DEPEND ON PAVEMENT TYPE AS FOLLOWS: S4.75A 1/2", S9.5B 1", S9.5C,D 1.5" - 2". ULTRA-THIN HOT MIX ASPHALT - TYPE A 3/4". ULTRA-THIN HOT MIX ASPHALT - TYPE B 5/8". ULTRA-THIN HOT MIX ASPHALT - TYPE C 1/2". THE MAXIMUM THICKNESS SHOULD DEPEND ON PAVEMENT TYPE AS FOLLOWS: S4.75A 1", S9.5B 1.5", S9.5C,D 2". ULTRA-THIN HOT MIX ASPHALT - TYPE A 3/4", ULTRA-THIN HOT MIX ASPHALT - TYPE B 5/8", ULTRA-THIN HOT MIX ASPHALT - TYPE C 1/2".

NOTES

ALL UNPAVED ROADS TO BE RESURFACED 50' FROM EDGE OF PAVEMENT OF MAIN PROJECT. ALL PAVED S. R. ROADS TO BE RESURFACED TO THE ENDS OF THE RADII, OR AS DIRECTED BY THE ENGINEER.

EDGES, PAVEMENT WIDENING, INTERSECTIONS AND BRIDGE FLARES ARE INCLUDED IN THE TABLE OF QUANTITIES.

SHOULDERS AND DITCHES ARE TO BE CONSTRUCTED BY OTHERS UNLESS OTHERWISE INDICATED.

BRIDGES ARE TO BE RESURFACED AT LOCATIONS AND TO DEPTH AS DIRECTED BY THE ENGINEER.

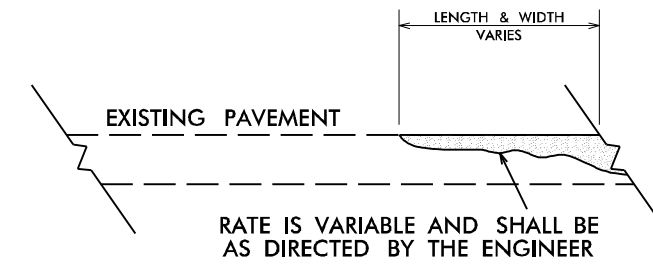
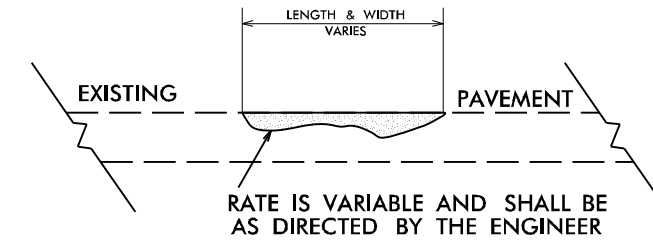

DETAIL SHOWING METHOD OF WEDGING

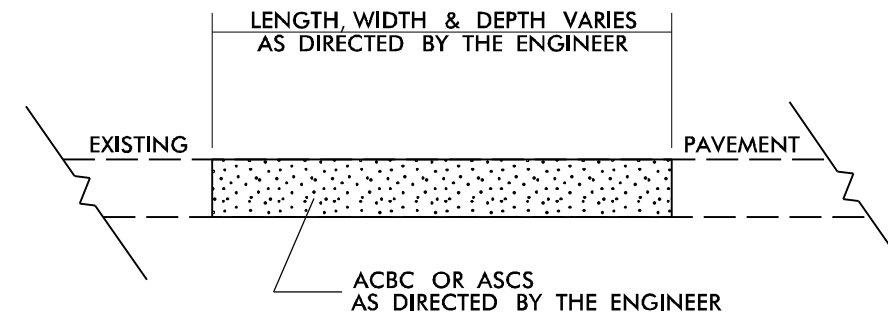

PATCHING EXISTING PAVEMENT

6/2/99
 26-JAN-2022 07:24
 S:\DD\Resurfacing\2023 Resurfacing\District 2\Mitchell-Yancey CR.2023.ddc.tjy.dgn
 \$\$\$\$ \$\$\$\$\$\$

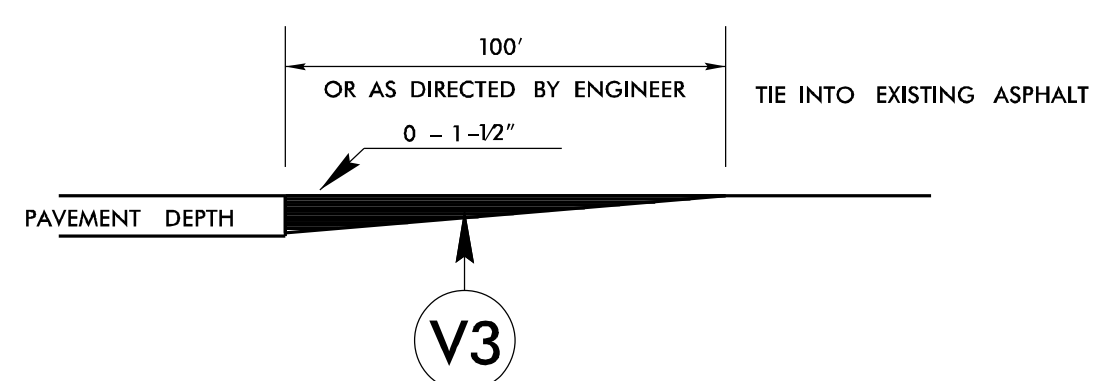

DETAIL TO TIE INTO EXIST PAVEMENT
 THE CONTRACTOR'S ATTENTION IS DIRECTED TO THE FACT THAT HE WILL BE REQUIRED TO MILL THE EXISTING ASPHALT PAVEMENT TO ENSURE A PROPER TIE-IN WITH THE EXISTING SURFACE AT THE BEGINNING, END AND Y LINES OF EACH MAP TO BE RESURFACED WITH ASPHALT CONC SURFACE COURSE, TYPE S9.5C. THIS WILL BE PAID FOR AS INCIDENTAL MILLING.

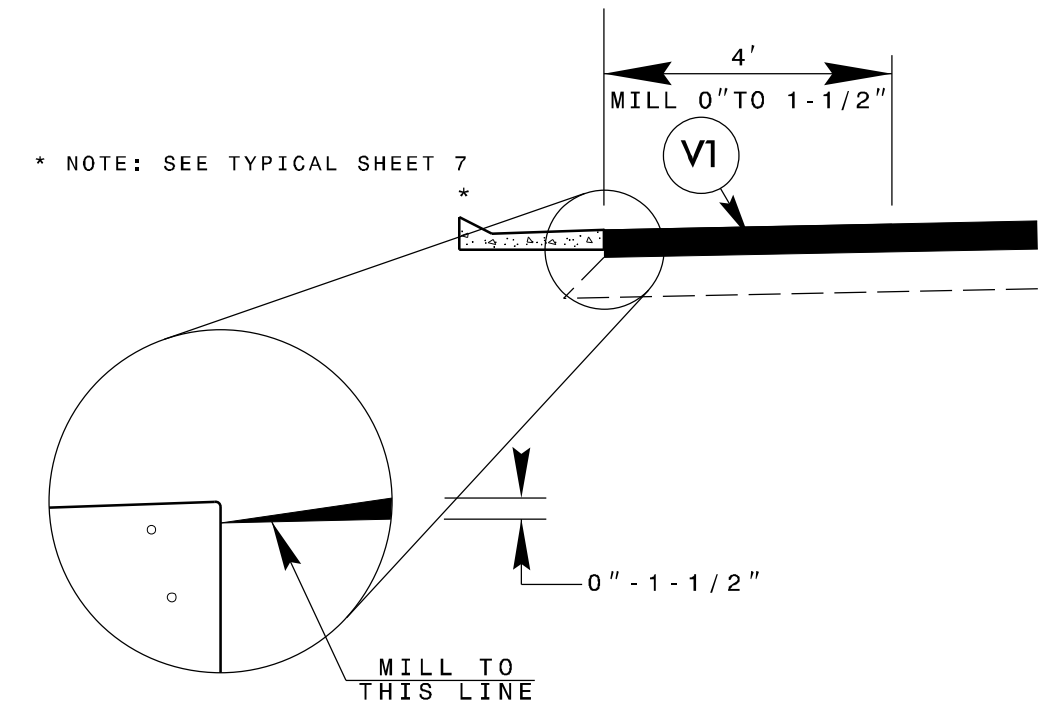

CONCRETE GUTTER MILLING DETAIL
 CONCRETE CUTTER LOCATED ON THE OUTSIDE EDGE OF PAVEMENT IN VARIOUS LOCATIONS OF MAP 6

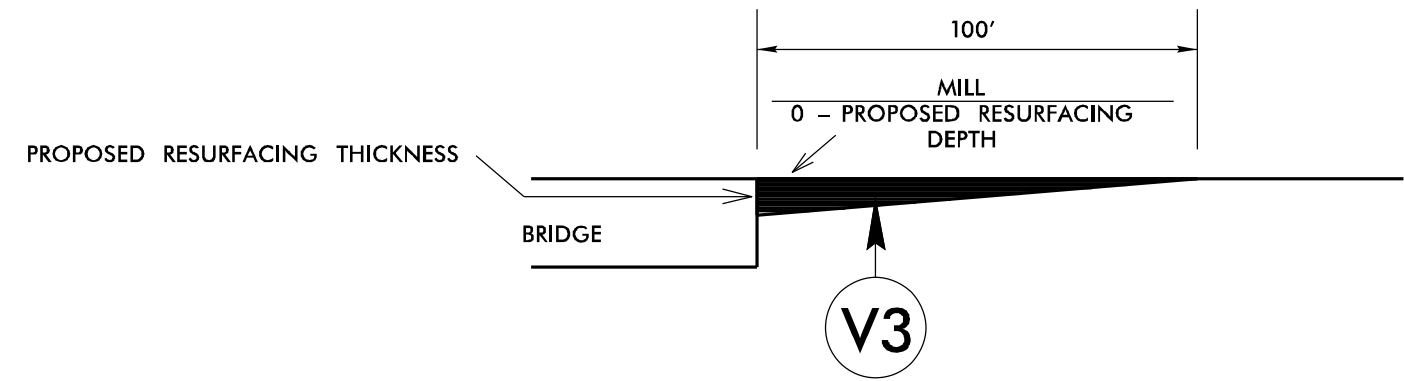

MILLING DETAIL AT BRIDGE APPROACHES
 WHERE BRIDGES WILL NOT BE RESURFACED. THIS WILL BE PAID FOR AS INCIDENTAL MILLING. USE AT BRIDGE NUMBER: 309 AND 320 MAP 7.

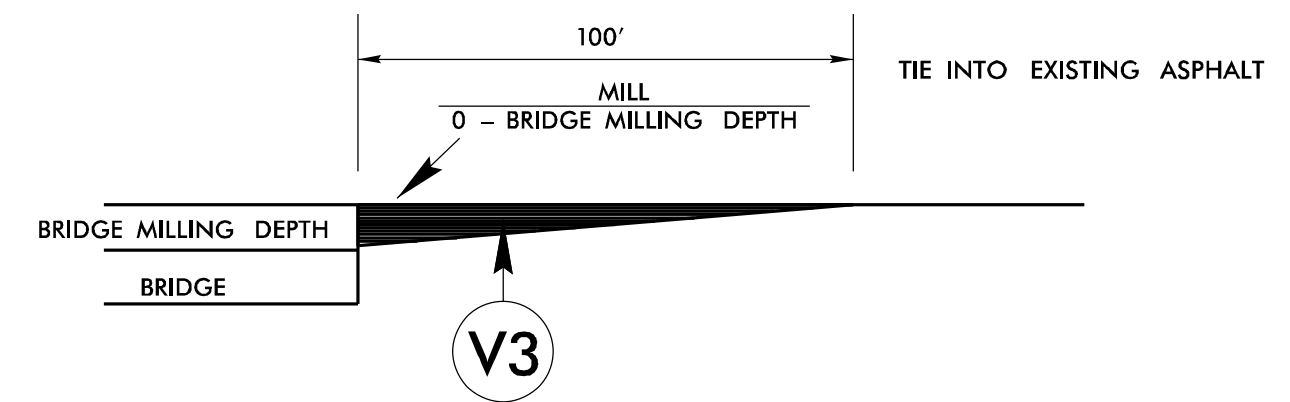

MILLING DETAIL AT BRIDGE APPROACHES
 WHERE BRIDGES WILL BE MILLED THEN RESURFACED. THIS WILL BE PAID FOR AS INCIDENTAL MILLING. USE AT BRIDGE NUMBER: 177 AND 19 Map 4, 121 Map 12.

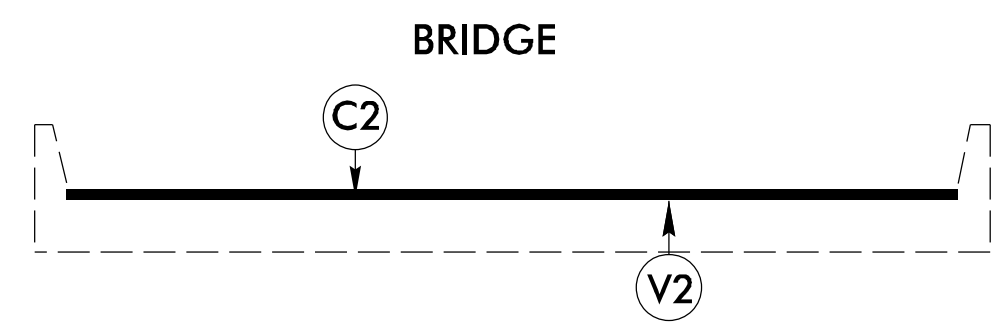

BRIDGE DETAIL
 BRIDGE NUMBER 177 AND 19 MAP 4, 121 MAP 12.

MILL 1-1/2" OFF EXISTING PAVEMENT
 SEE MAP FOR BRIDGE LOCATION.

6/2/99
 26-JAN-2022 07:24
 S:\DDC\Resurfacing\2023 Resurfacing\District 2\Mitchell-Yancey CR.2023.ddc.typ.dgn
 \$\$\$\$

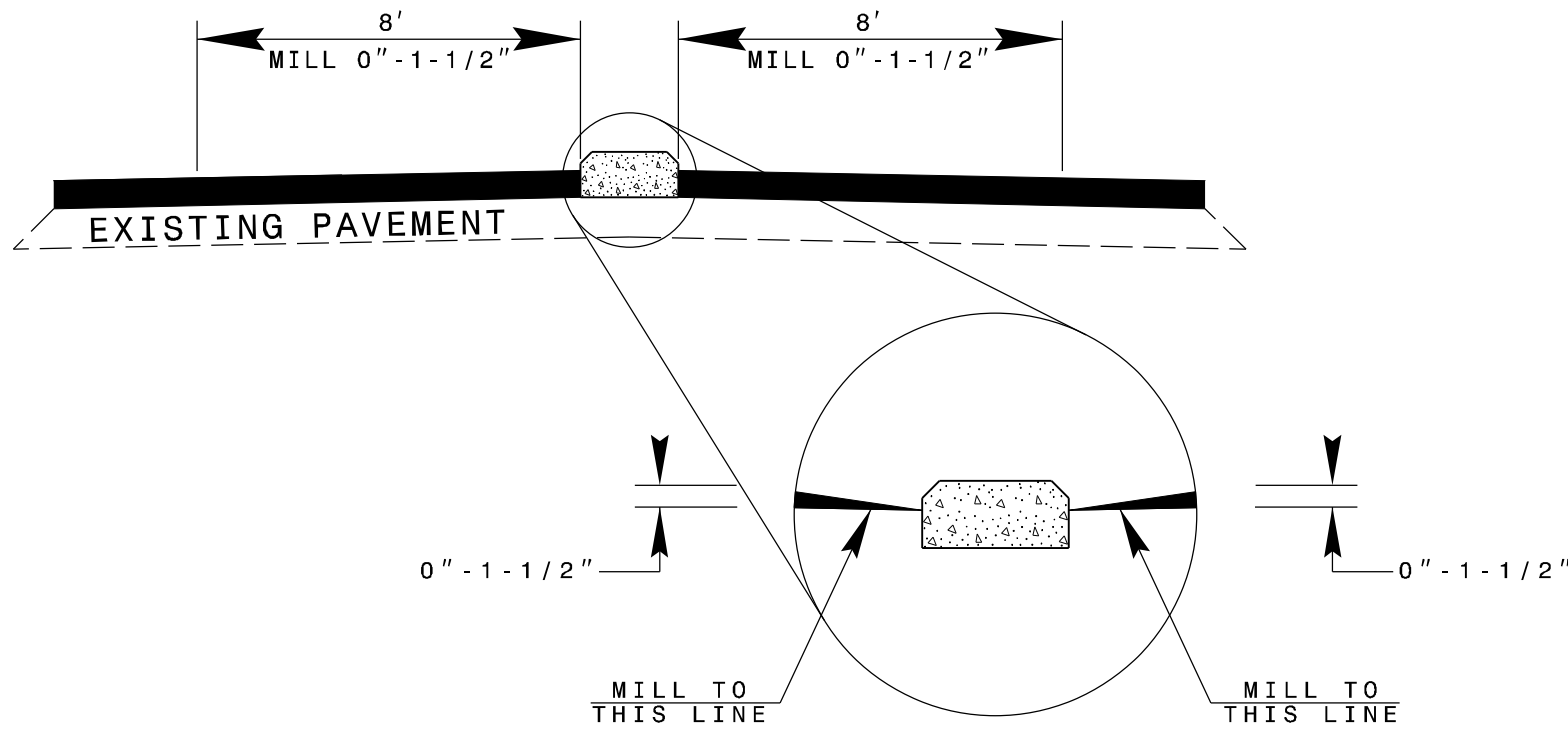

MILLING DETAIL AROUND ISLANDS ON -Y- LINES

MILLING AROUND ISLANDS.
THIS WILL BE PAID FOR AS 0" TO 1-1/2".
USE ON MAP NUMBER: MAP 4 AND 7.

PROJECT NO. 2023CPT.13.05.10611, 2023CPT.13.05.20611, ETC.	SHEET NO. 12	TOTAL NO. 19
--	-----------------	-----------------

NOTES:

- 1) DETAIL DOES NOT APPLY TO OGAFCC AND ULTRA-THIN BONDED WEARING COURSE.
- 2) BACKFILL SHOULDER WITH APPROVED MATERIAL.
- 3) THE SHOULDER WEDGE DEVICE MAY BE DISENGAGED AT PAVED DRIVEWAYS, SIDE STREETS, HIGH SHOULDERS, AND OTHER LOCATIONS NOT FEASIBLE TO CONSTRUCT AS APPROVED BY THE ENGINEER.

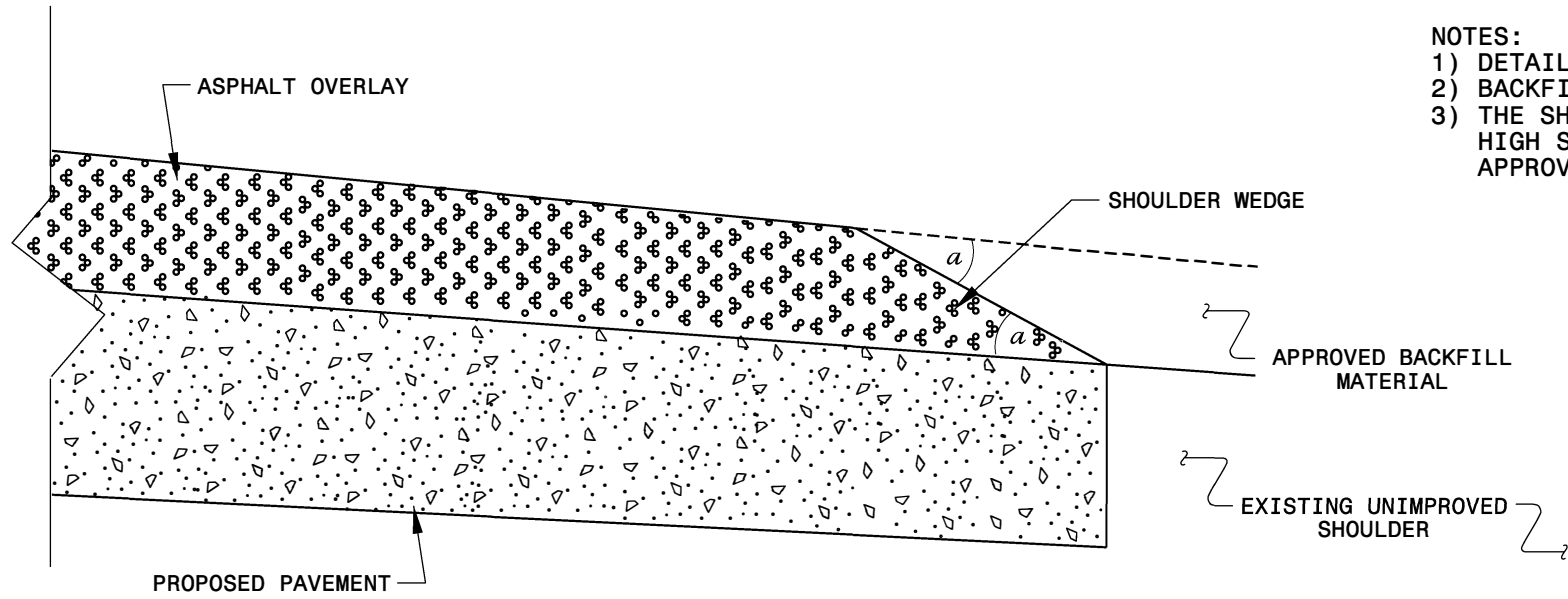

SHOULDER WEDGE DETAIL

(Resurfacing Projects w/ Widening or with Existing Paved Shoulder having no dropoffs)

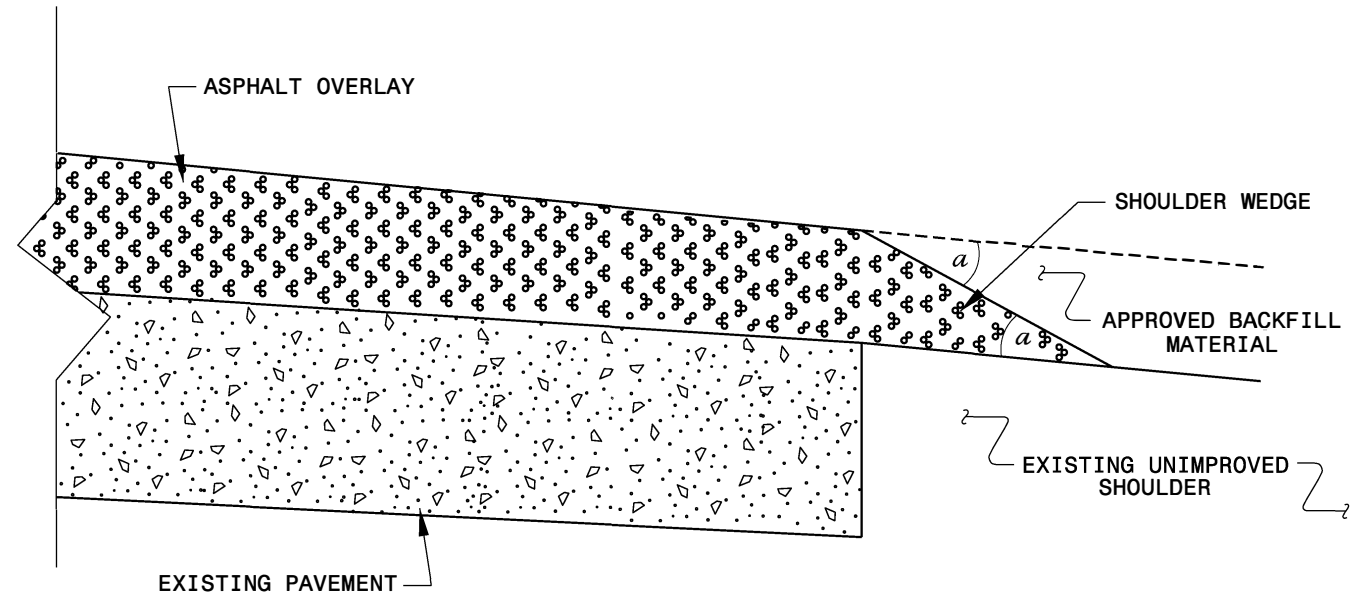

SHOULDER WEDGE DETAIL

(Resurfacing Projects w/ NO Widening)

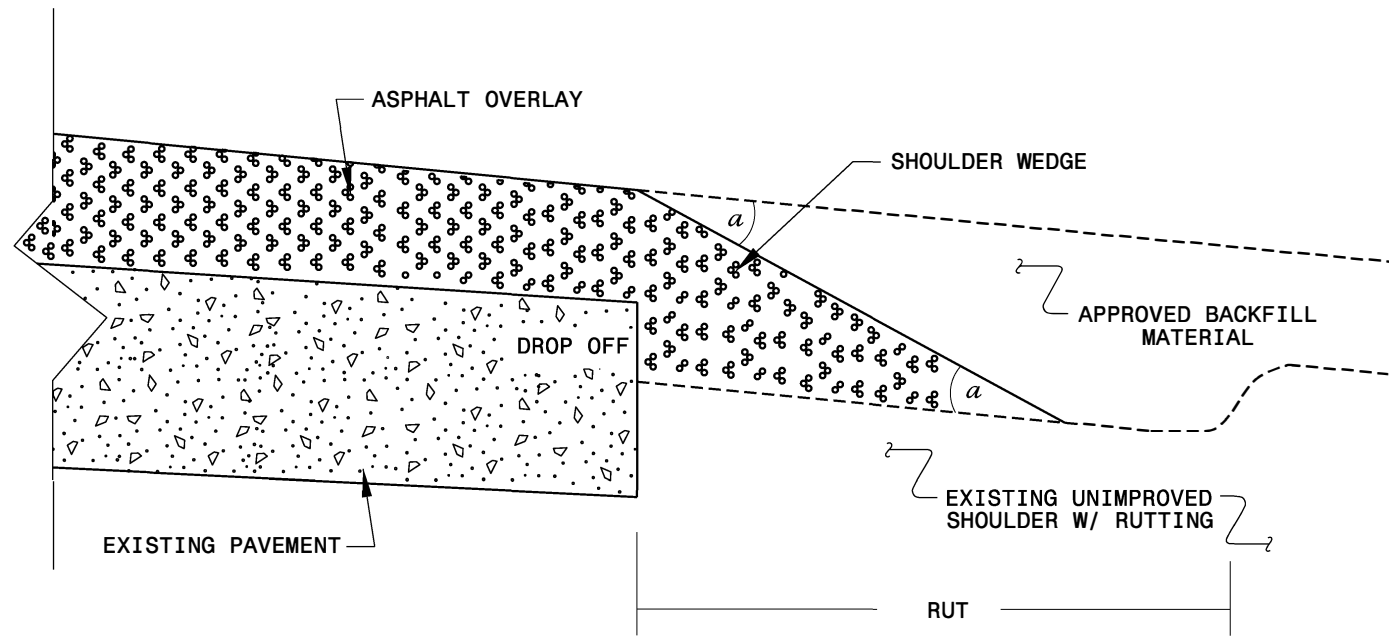

SHOULDER WEDGE DETAIL

(Resurfacing Adjacent to Rutted Shoulder)

- SHOULDER WEDGE ANGLE = 30°



CONTRACT STANDARDS AND DEVELOPMENT UNIT
Office 919-707-6950 FAX 919-250-4119

SHOULDER WEDGE DETAILS

ORIGINAL BY: T. SPELL DATE: 7-19-11
 MODIFIED BY: DATE: 2/2/16
 CHECKED BY: DATE:
 FILE SPEC.: s:\usr\details\stand\shoulderwedgedetail.dgn

DOCUMENT NOT CONSIDERED FINAL UNLESS ALL SIGNATURES COMPLETED

PROJECT NO.	SHEET NO.	TOTAL NO.
2023CPT.13.05.10611, 2023CPT.13.05.20611, ETC.	13	19

SUMMARY OF QUANTITIES

PROJECT NO	COUNTY	MAP NO	ROUTE	DESCRIPTION	TYP NO	LANES	LANE TYPE	FINAL SURFACE TESTING REQUIRED	WARM MIX ASPHALT REQUIRED	LENGTH	WIDTH	1220000000-E	1245000000-E	1260000000-E	1297000000-E	1308000000-E	1330000000-E	1519000000-E	1523000000-E	1575000000-E	1693000000-E	1704000000-E	2549000000-E	2591000000-E	2613000000-N	2815000000-N	2830000000-N	2845000000-N			
												INCIDENTAL STONE BASE	SHOULDER RECONSTRUCTION	AGGREGATE SHOULDER BORROW	MILLING ASPHALT PAVEMENT, 1-1/2" DEPTH	MILLING ASPHALT PAVEMENT, 0" TO 1-1/2" DEPTH	INCIDENTAL MILLING	ASPHALT CONC SURFACE COURSE, TYPE S9.5B	ASPHALT CONC SURFACE COURSE, TYPE S9.5C	ASPHALT BINDER FOR PLANT MIX	ASPHALT PLANT MIX, PAVEMENT REPAIR	PATCHING EXISTING PAVEMENT	2'-6" CONCRETE CURB & GUTTER	4" CONCRETE SIDEWALK	REMOVE AND REPLACE CURB RAMPS	ADJUSTMENT OF DROP INLET	ADJUSTMENT OF MANHOLES	ADJUSTMENT OF METER BOXES OR VALVE BOXES			
										MI	FT	TON	SMI	TON	SY	SY	SY	TON	TON	TON	TON	TON	LF	SY	EA	EA	EA	EA			
2023CPT.13.05.10611	Mitchell	1	NC 226	FROM SR 1250 TO NC 226A (MP 10.35 - MP 12.02)	1	2	2WU	NO	NO	1.65	33	83	3.30	429			1,966		2,885	173				373							
2023CPT.13.05.10611	Mitchell	2	NC 226	FROM SCL BAKERSVILLE TO NC 261 (MP 14.30 - MP 17.38)	1,2,3,7	2	2WU	NO	NO	4.06	27	153	6.13	797	6,178	2,072	3,078		4,298	258	5		358	80	44	13	1	2	3		
2023CPT.13.05.10611	Mitchell	3	NC 226A	FROM NC 226 TO NC 80 (MP 0.00 - MP 1.66)	1	2	2WU	NO	NO	1.66	22	83	3.32	432			1,139		1,896	114				350							
2023CPT.13.05.10611	Mitchell	4	NC 261	FROM NC 226 TO NCL BAKERSVILLE (MP 0.00 - MP 0.55)	1	2	2WU	NO	NO	0.49	20	25	0.98	128			242		504	30				100				1			
TOTAL FOR PROJ NO. 2023CPT.13.05.10611												7.86		344	13.73	1,786	6,178	2,072	6,425		9,583	575	5	1,181	80	44	13	1	3	3	
2023CPT.13.05.20611	Mitchell	5	SR 1128 (HENREDON RD/HUMPBACK MOUNTAIN RD)	FROM SR 1121 TO SR 1126 (MP 0.00 - MP 2.82)	5	2	2WU	NO	NO	2.82	21	139	5.54	720					2,870					154							
TOTAL FOR PROJ NO. 2023CPT.13.05.20611												2.82		139	5.54	720				2,870				154							
2023CPT.13.07.11001	Yancey	6	US 19 EAST AND WEST	FROM SR 1128 +1.65 MILES (MP 0.00 - MP 1.65)	4	4	MD	NO	NO	1.65	76	85	3.44	447	667	25,321	6,069		7,812	468				475							
TOTAL FOR PROJ NO. 2023CPT.13.07.11001												1.65		85	3.44	447	667	25,321	6,069		7,812	468		475							
2023CPT.13.07.21001	Yancey	7	SR 1144 (BEAR WALLOW RD)	FROM PVMT JOINT AT US 19E TO PVMT JNT AT US 19E (MP 0.00 - MP 1.70)	5	2	2WU	NO	NO	1.70	25.5	85	3.40	442	176				2,285					200							
2023CPT.13.07.21001	Yancey	8	SR 1376 (WHEELER HILLS)	FROM SR 1196 TO SR 1455 (MP 0.00 - MP 0.09)	5	2	2WU	NO	NO	0.19	22	10	0.38	99			65		223					525							
2023CPT.13.07.21001	Yancey	9	SR 1455 (WHEELER HILLS)	FROM SR 1376 TO EOM (MP 0.00 - MP 0.180)	5	2	2WU	NO	NO	0.18	20.5	9	0.36	94			138		197					90					2		
2023CPT.13.07.21001	Yancey	10	SR 1136 (PRICES CREEK RD)	FROM US 19E TO SR 1126 (MP 0.06 - MP 0.48)	6	2	2WU	NO	NO	0.42	23	21	0.84	218					514					110							
2023CPT.13.07.21001	Yancey	11	SR 1395 (BALD MTN. RD)	FROM SR 1140 + 0.3 MILES TO SR 1140 + 1.3 MILES (MP 5.12 - MP 6.12)	5	2	2WU	NO	NO	1.00	20	50	2.00	260			1,189		968					120							
2023CPT.13.07.21001	Yancey	12	SR 1139 (FERGUSON HILL)	FROM NC US 19E TO NC 1975 (MP 0.00 - MP 0.95)	5	2	2WU	NO	NO	0.95	23	46	1.90	494					1,164					290					2		
TOTAL FOR PROJ NO. 2023CPT.13.07.21001												4.44		221	8.88	1,607	176	203	1,189		5,351			1,335							
GRAND TOTAL												16.77		789	31.59	4,560	7,021	27,596	13,683	8,221	17,395	1,587	5	3,145	80	44	13	1	3	5	

PROJECT NO.	SHEET NO.	TOTAL NO.
2023CPT.13.05.10611, 2023CPT.13.05.20611, ETC.	14	19

THERMOPLASTIC AND PAINT QUANTITIES

PROJECT NO	COUNTY	MAP NO	ROUTE	DESCRIPTION	TYP NO	LANES	LANE TYPE	LENGTH	WIDTH	4405000000-E	4410000000-E	4413000000-E	4447000000-E	4457000000-N	4600000000-N		4810000000-E		4890000000-N											
										WORK ZONE SIGNS (PORTABLE)	WORK ZONE SIGNS (BARRICADE MOUNTED)	WORK ZONE ADVANCE/GENERAL WARNING SIGNING	PEDESTRIAN CHANNELIZING DEVICES	TEMPORARY TRAFFIC CONTROL	AUDIBLE WARNING DEVICES	TEMPORARY CURB RAMPS	PAINT PAVEMENT MARKING LINES (4") YELLOW	PAINT PAVEMENT MARKING LINES (4") WHITE	THERMOPLASTIC PAVEMENT MARKING LINES (8", 90 MILS) WHITE	THERMOPLASTIC PAVEMENT MARKING LINES (24" 90 MILS) WHITE (HI-VIS X-WALK)	POLYUREA PAVMENT MARKING LINES (4", 20 MILS) YELLOW (STANDARD GLASS BEADS)	POLYUREA PAVEMENT MARKING LINES (4", 20 MILS) WHITE (STANDARD GLASS BEADS)	THERMOPLASTIC PAVEMENT CHARACTER (90 MILS) SCHOOL	THERMOPLASTIC PAVEMENT MARKING SYMBOL (90 MILS) LT ARROW	THERMOPLASTIC PAVEMENT MARKING SYMBOL (90 MILS) RT ARROW	THERMOPLASTIC PAVEMENT MARKING SYMBOL (90 MILS) STR ARROW	THERMOPLASTIC PAVEMENT MARKING SYMBOL (90 MILS) LT & STR ARROW	NON-CAST IRON SNOWPLOWABLE PAVEMENT MARKERS		
MI	FT	SF	SF	SF	LF	LS	EA	EA	LF	LF	LF	LF	LF	EA	EA	EA	EA	EA	EA	EA	EA	EA								
2023CPT.13.05.10611	Mitchell	1	NC 226	FROM SR 1250 TO NC 226A (MP 10.35 - MP 12.02)	1	2	ZWU	1.65	33			185							17,410	17,410							110			
2023CPT.13.05.10611	Mitchell	2	NC 226	FROM SCL BAKERSVILLE TO NC 261 (MP 14.30 - MP 17.38)	1,2,3,7	2	ZWU	4.06	27	20	10	422	10	*	1	1	4,118	1,800	492	130	32,350	32,350	6				205			
2023CPT.13.05.10611	Mitchell	3	NC 226A	FROM NC 226 TO NC 80 (MP 0.00 - MP 1.66)	1	2	ZWU	1.66	22			186									17,530	17,530					111			
2023CPT.13.05.10611	Mitchell	4	NC 261	FROM NC 226 TO NCL BAKERSVILLE (MP 0.00 - MP 0.55)	1	2	ZWU	0.49	20			55									5,184	5,184					33			
TOTAL FOR PROJ NO. 2023CPT.13.05.10611									7.86		20	10	848	10	*	1	1	4,118	1,800	492	130	72,474	72,474	6				459		
															5,918		144,948													
2023CPT.13.05.20611	Mitchell	5	SR 1128 (HENREDON RD/HUMPBACK MOUNTAIN RD)	FROM SR 1121 TO SR 1126 (MP 0.00 - MP 2.82)	5	2	ZWU	2.82	21			310		*																
TOTAL FOR PROJ NO. 2023CPT.13.05.20611									2.82				310	*				58,528	58,528											
															117,056															
2023CPT.13.07.11001	Yancey	6	US 19 EAST AND WEST	FROM SR 1128 +1.65 MILES (MP 0.00 - MP 1.65)	4	4	MD	1.65	76			194		*							1,275	32,735		26	8	31	2	418		
TOTAL FOR PROJ NO. 2023CPT.13.07.11001									1.65				194	*							1,275	32,735		26	8	31	2	418		
																	34,010		67											
2023CPT.13.07.21001	Yancey	7	SR 1144 (BEAR WALLOW RD)	FROM PVMT JOINT AT US 19E TO PVMT JNT AT US 19E (MP 0.00 - MP 1.70)	5	2	ZWU	1.7	25.5			190		*																
2023CPT.13.07.21001	Yancey	8	SR 1376 (WHEELER HILLS)	FROM SR 1196 TO SR 1455 (MP 0.00 - MP 0.09)	5	2	ZWU	0.19	22			22																		
2023CPT.13.07.21001	Yancey	9	SR 1455 (WHEELER HILLS)	FROM SR 1376 TO EOM (MP 0.00 - MP 0.180)	5	2	ZWU	0.18	20.5			20																		
2023CPT.13.07.21001	Yancey	10	SR 1136 (PRICES CREEK RD)	FROM US 19E TO SR 1126 (MP 0.06 - MP 0.48)	6	2	ZWU	0.42	23			48																		
2023CPT.13.07.21001	Yancey	11	SR 1395 (BALD MTN. RD)	FROM SR 1140 + 0.3 MILES TO SR 1140 + 1.3 MILES (MP 5.12 - MP 6.12)	5	2	ZWU	1.00	20			112																		
2023CPT.13.07.21001	Yancey	12	SR 1139 (FERGUSON HILL)	FROM NC US 19E TO NC 1975 (MP 0.00 - MP 0.95)	5	2	ZWU	0.95	23			106																		
TOTAL FOR PROJ NO. 2023CPT.13.07.21001									4.44				498	*				35,904	35,904			4,013	4,013			3,802	3,802			
															187,546															
GRAND TOTAL									16.77		20	10	1,850	10	1	1	1	156,419	154,101	492	130	73,749	105,209	6	26	8	31	2	877	
															310,520		178,958						67							

URBAN / SUBURBAN WORKZONES

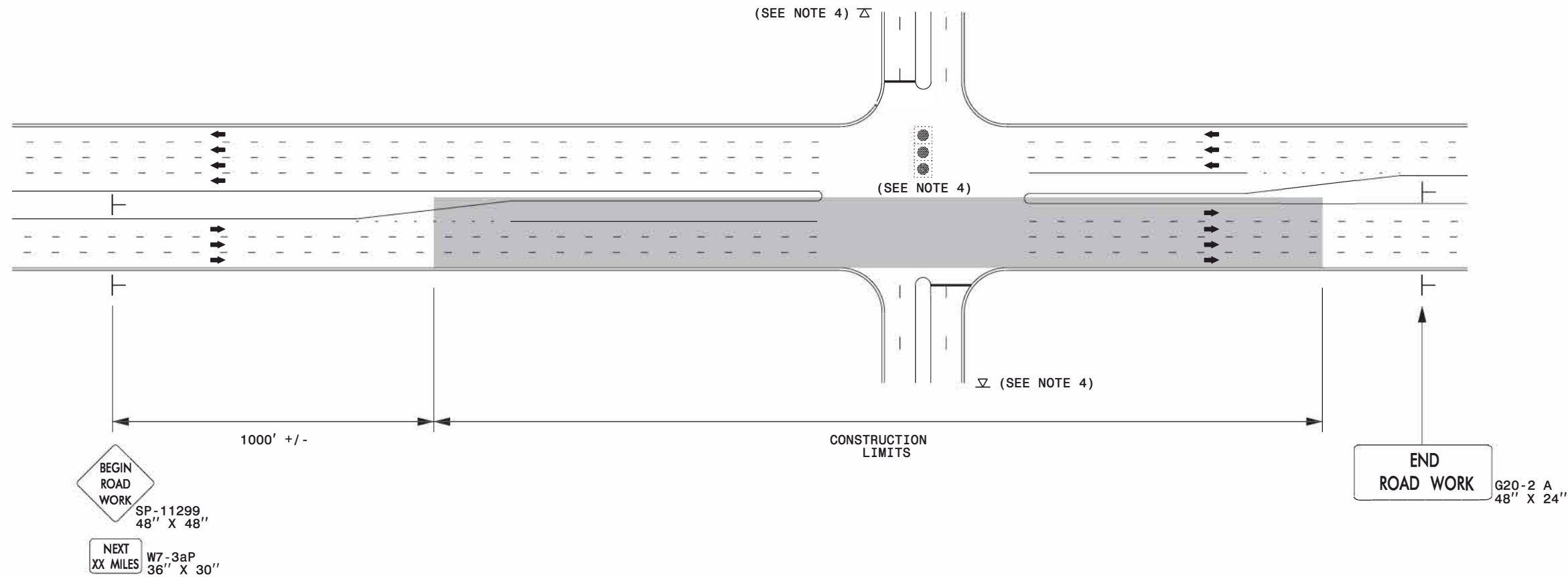

NOTES:

- 1) 48" x 48" SIZED SIGNS (SP- 11299) MAY BE REDUCED TO 36" X 36" ON ROADWAYS WITH SPEED LIMITS OF 40 MPH OR LESS.
- 2) MOUNT SIGNS THAT ARE LARGER THAN 10 SQUARE FEET IN AREA ON TWO OR MORE WOOD OR U-CHANNEL SUPPORTS. PERFORATED SQUARE TUBING SUPPORT SYSTEMS MAY SUPPORT LARGER AREAS ON A SINGLE SUPPORT. FOLLOW MANUFACTURER'S RECOMMENDATIONS. THESE SYSTEMS SHALL BE NCHRP 350 COMPLIANT AND NCDOT APPROVED.
- 3) ADVANCE WARNING SIGNS NOT REQUIRED ON NON-SIGNALIZED SIDE STREETS.
- 4) MAY USE LAW ENFORCEMENT TO CONTROL TRAFFIC AT SIGNALIZED INTERSECTIONS AS DIRECTED BY THE ENGINEER. PROVIDE PORTABLE "ROAD WORK AHEAD" (W20-1) SIGNS 500' IN ADVANCE ALONG BOTH APPROACHES FROM THE SIDE STREETS WHEN PAVING PROCEEDS THROUGH THE INTERSECTION.
- 5) LATERAL CLEARANCE AT ALL SIGN LOCATIONS SHALL BE 2' AS MEASURED FROM THE EDGE OF PAVEMENT OR THE FACE OF THE CURB. WHEN UNABLE TO OBTAIN THE LATERAL CLEARANCE WITHIN THE MEDIAN AREA USE SHOULDER MOUNTS ONLY.
- 6) SIGN MOUNT LOCATIONS SHALL NOT BLOCK SIDEWALKS OR DRIVEWAYS.
- 7) IF STATIONARY GENERAL WARNING SIGNS ARE USED, THEY WILL BE PAID FOR PER SECTION 104 OF THE NCDOT STANDARD SPECIFICATIONS AS EXTRA WORK.
- 8) IF MILLED AREAS ARE NOT PAVED BACK BY THE END OF THE WORK DAY, PORTABLE SIGNS SHALL BE USED TO WARN DRIVERS OF THE PRESENT CONDITIONS. THESE ARE TO INCLUDE, BUT NOT LIMITED TO "ROUGH ROAD" W8-8, "UNEVEN LANES" W8-11, "GROOVED PAVEMENT" W8-15 w/MOTORCYCLE PLAQUE MOUNTED BELOW. THESE ARE TO BE DOUBLE INDICATED ON MULTI-LANE ROADWAYS WITH SPEED LIMITS 45 MPH AND GREATER WHERE LATERAL CLEARANCE CAN BE OBTAINED WITHIN THE MEDIAN AREAS. THESE PORTABLE SIGNS ARE INCIDENTAL TO THE OTHER ITEMS OF WORK INCLUDED IN THE TEMPORARY TRAFFIC CONTROL (LUMP SUM) PAY ITEM.

LEGEND

- STATIONARY SIGN
- DIRECTION OF TRAFFIC FLOW



**RESURFACING ADVANCE
WARNING SIGNS FOR
URBAN / SUBURBAN
FACILITIES**

SIGNING FOR RESURFACING PROJECTS

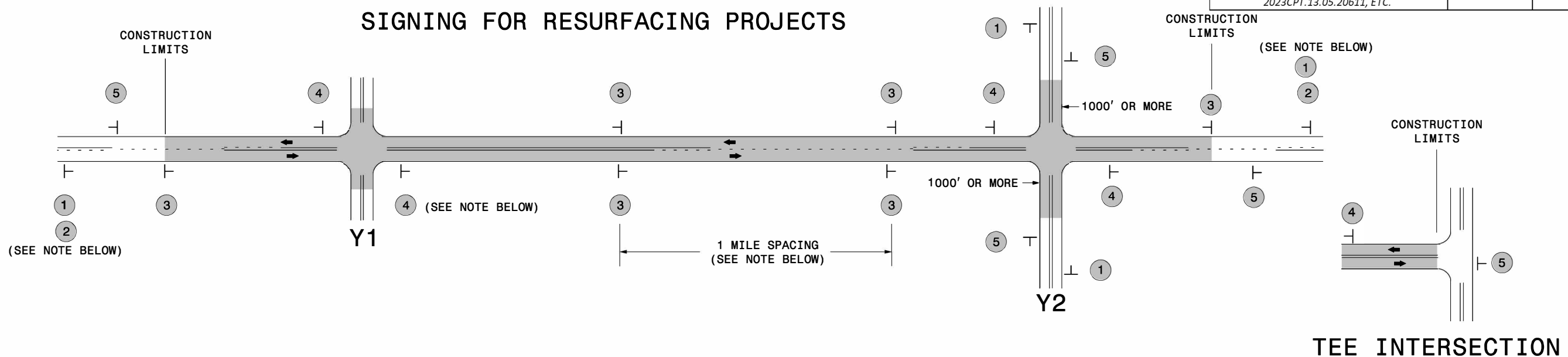

MAINLINE (-L-) SIGNING

-Y- LINE SIGNING

SIGNING NOTES AND PLACEMENT PER DIRECTION	MAINLINE (-L-) SIGNING		-Y- LINE SIGNING	
	1	 W20-1 48" X 48"	<p>PLACE 1000' PRIOR TO BEGINNING OF CONSTRUCTION LIMITS. ONLY USED ON -Y- LINES IF RESURFACING LIMITS EXTEND 1000' ALONG -Y- LINE.</p>	<p>NO REQUIRED STATIONARY SIGNING FOR THE FOLLOWING -Y- LINE CONDITIONS:</p> <ol style="list-style-type: none"> 1) LESS THAN 1000' OF RESURFACING ALONG -Y- LINE 2) SUBDIVISION ROADS 3) DEAD END ROADS <p>WHEN PAVING/CONSTRUCTION ACTIVITIES PROCEED ACROSS AN UNSIGNED -Y- LINE, ADVANCE WARNING PORTABLE SIGNS SHALL BE USED ALONG THE -Y- LINE AS SHOWN BELOW. REMOVE UPON COMPLETION OF WORK.</p> <div style="display: flex; justify-content: space-around;"> <div style="text-align: center;"> <p>W20-1 48" X 48"</p> </div> <div style="text-align: center;"> <p>W20-7 A 48" X 48"</p> </div> </div> <p>PLACED 500' IN ADVANCE OF FLAGGER. PLACED 250' IN ADVANCE OF FLAGGER.</p>
	2	 W7-3aP 24" X 18"	<p>#2 SIGN ONLY USED WHEN RESURFACING LIMITS ARE 2 OR MORE MILES IN LENGTH. ROUND UP TO NEXT WHOLE NUMBER. (NO FRACTIONAL OR DECIMAL NUMBERS)</p>	
	3	 SP 13107 48" X 48"	<ul style="list-style-type: none"> - PLACE INITIALLY AT THE CONSTRUCTION LIMITS AND SPACE 1 MILE APART THEREAFTER. - AT TEE INTERSECTIONS INSTALL INITIALLY 0.5 MILE FROM INTERSECTION AND SPACE 1 MILE APART THEREAFTER. 	
	4	 SP 13106 48" X 48"	<ul style="list-style-type: none"> - THESE ARE FOR -Y- LINES THAT ARE "THROUGH" ROADWAYS. - DEAD END AND SUBDIVISION ROADS ARE NOT "THROUGH" ROADWAYS. - INSTALL 500' +/- FROM EACH -Y- LINE APPROACH AS SHOWN ABOVE. - FOR MULTIPLE -Y- LINES THAT ARE SEPARATED BY 0.25 MILES OR LESS, TREAT AS A SINGLE UNIT AND INSTALL WITHIN 500' OF EACH APPROACH. - A MAXIMUM OF 2 SIGN SETS PER MILE. DO NOT INSTALL WHEN -Y- LINES ARE WITHIN 0.5 MILES FROM "END ROAD WORK" SIGN. - FOR TEE INTERSECTIONS, INSTALL WITHIN 500' +/- OF THE INTERSECTION ALONG -L- LINE. 	
5	 G20-2 A 48" X 24"	<p>PLACE 500' FOLLOWING THE END OF CONSTRUCTION LIMITS OR AS SHOWN WHEN WORK ENDS AT A 3-WAY TEE INTERSECTION.</p>		

**RESURFACING
ADVANCE WARNING SIGNS
FOR
RURAL AND SUBURBAN
2 LANE ROADWAYS**

SIGN NUMBER: 11299

BACKG COLOR: Fluorescent Orange

DESIGN BY: WJ

CHECKED BY:

DATE: Jun 22, 2011

TYPE: B

COPY COLOR: Black

PROJECT ID: ALL

DIV: ALL

QUANTITY: SEE PLANS

SYMBOL	X	Y	WID	HT

SIGN WIDTH: 5'-6"

HEIGHT: 5'-6"

TOTAL AREA: 30.5 Sq.Ft.

BORDER TYPE: INSET

RECESS: 0.59"

WIDTH: 0.75"

RADII: 1.38"

NO. Z BARS: N/A

LENGTH: N/A

MAT'L: 0.125" (3.2 mm) ALUMINUM

SP 11299

PROJECT NO.	SHEET NO.	TOTAL NO.
2023CPT.13.05.10611, 2023CPT.13.05.20611, ETC.	17	19

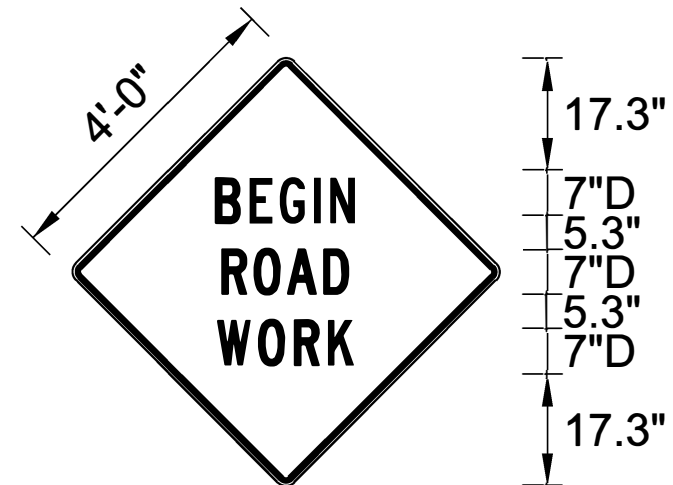

BORDER
R=1.38"
TH=0.75"
IN=0.59"

Spacing Factor is 1 unless specified otherwise

USE NOTES: 1,2

- Legend and border shall be direct applied black non-reflective sheeting.
- Background shall be Type VII, VIII, or IX (prismatic) fluorescent orange retroreflective sheeting.

LETTER POSITIONS

Letter spacings are to start of next letter																				Series/Size	
																				Text Length	
		B	E	G	I	N															D 2000
	20.5	6	5.4	6.3	2.8	4.8	20.5														25.2
		R	O	A	D																D 2000
	21.4	5.8	5.9	7	4.8	21.4															23.5
		W	O	R	K																D 2000
	20.9	7.1	6.5	5.9	4.9	20.9															24.5

SIGN NUMBER: SP13106
TYPE: STATIONARY
QUANTITY: SEE PLANS

BACKG COLOR: Fluorescent Orange
COPY COLOR: Black

DESIGN BY: B. RASHID
PROJECT ID:

CHECKED BY: AIA
DIV:

DATE: Apr 26, 2013

SIGN WIDTH: 4'-0"
HEIGHT: 4'-0"
TOTAL AREA: 16.00 Sq.Ft.

BORDER TYPE: INSET
RECESS: 0.75"
WIDTH: 1.25"
RADII: 3"

NO. Z BARS:
LENGTH:

SYMBOL	X	Y	WID	HT

MAT'L: 0.080" (2.0 mm) ALUMINUM

PROJECT NO.	SHEET NO.	TOTAL NO.
2023CPT.13.05.10611, 2023CPT.13.05.20611, ETC.	18	19

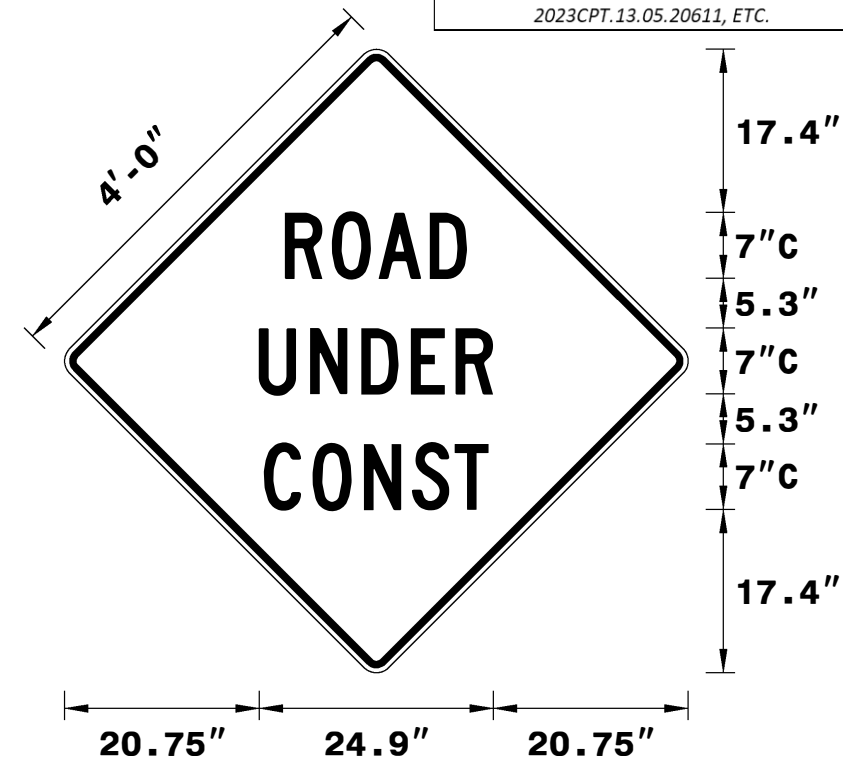

Spacing Factor is 1 unless specified otherwise

USE NOTES: 1,2

- Legend and border shall be direct applied black non-reflective sheeting.
- Background shall be NC GRADE B fluoresent orange retroreflective sheeting.

LETTER POSITIONS

Letter spacings are to start of next letter																			Series/Size Text Length
	R	O	A	D															C 2000
23.5	5	5	5.5	3.9	23.5														19.3
	U	N	D	E	R														C 2000
20.7	5.5	5.5	5.3	4.8	3.9	20.7													24.9
	C	O	N	S	T														C 2000
21.2	5.2	5.5	5.1	4.6	3.6	21.2													23.9

SIGN NUMBER: SP13107
 TYPE: STATIONARY
 QUANTITY: SEE PLANS

BACKG COLOR: Fluorescent Orange
 COPY COLOR: Black

DESIGN BY: B. RASHID
 PROJECT ID:

CHECKED BY: AIA
 DIV:

DATE: Apr 26, 2013

SYMBOL	X	Y	WID	HT

SIGN WIDTH: 4'-0"
 HEIGHT: 4'-0"
 TOTAL AREA: 16.00 Sq.Ft.

BORDER TYPE: INSET
 RECESS: 0.75"
 WIDTH: 1.25"
 RADII: 3"

NO. Z BARS:
 LENGTH:

MAT'L: 0.080" (2.0 mm) ALUMINUM

PROJECT NO.	SHEET NO.	TOTAL NO.
2023CPT.13.05.10611, 2023CPT.13.05.20611, ETC.	19	19

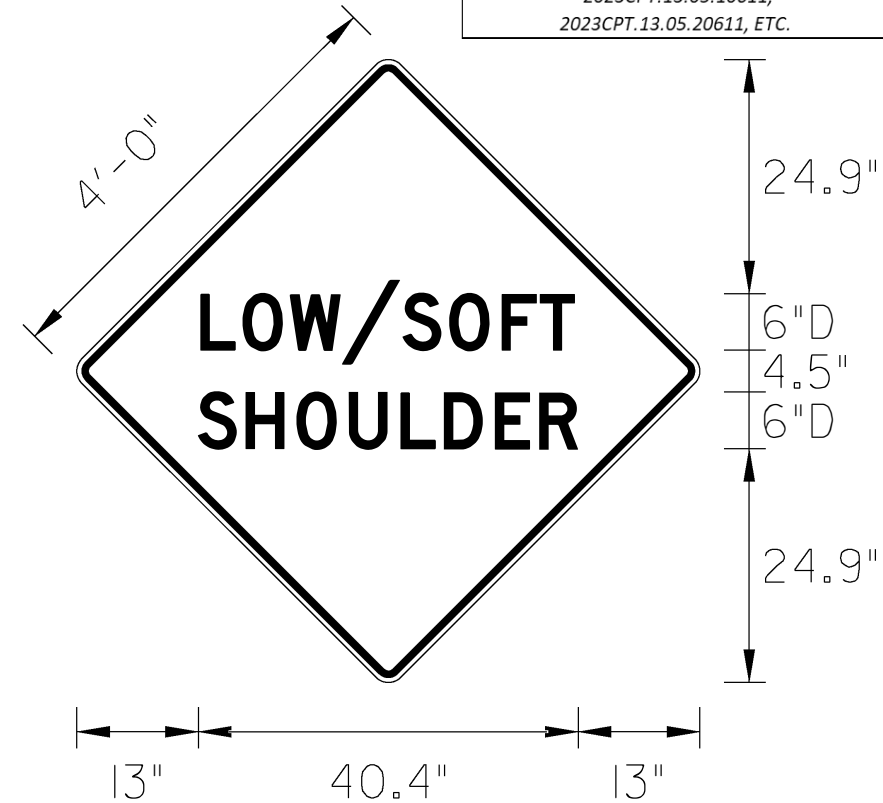

Spacing Factor is 1 unless specified otherwise

USE NOTES: 1,2

1. Legend and border shall be direct applied black non-reflective sheeting.
2. Background shall be NC GRADE B fluoesent orange retroreflective sheeting.

LETTER POSITIONS

Letter spacings are to start of next letter											Series/Size Text Length	
	L	O	W	/	S	O	F	T				D 2000
13.2	4.5	5	5.5	6.5	5	5.6	4.1	3.7	13.2			39.9
	S	H	O	U	L	D	E	R				D 2000
13	5.1	5.4	5.6	5.5	4.6	5.4	4.7	4.1	13			40.4